

# AQUILA 54



AQUILA

# Technical specification

**Length overall – 16.5 m / 54' 1"**

**Beam overall – 7.6 m / 24' 11"**

**Hull Draft – 0.74 m / 2' 5"**

**Max Draft – 1.2 m / 3' 11"**

**Air Draft – 5.95 m / 19' 6"**

**Light Ship Displacement – 27 t / 59 500 lbs**

**Design Category – A**

**Fuel Capacity – 2200L (720L range extenders) / 581 GAL (190 GAL range extenders)**

**Fresh water – 900L (230 GAL)**

**Generator - 1 x Kohler 16kW**

**Propulsion Standard – 2 x Volvo Penta D6-380 hp**

*Max Speed/Range – 19kts (22mph) / 415 Nm*

*Cruising Speed/Range – 16.5kts (19mph) / 480 Nm*

*Hull Speed/Range – 8kts (9.2mph) / 1160 Nm*

**Propulsion option 1 – 2 x Volvo Penta D6-480 hp**

*Max Speed/Range – 22.5kts (26mph) / 355 Nm*

*Cruising Speed/Range – 18kts (21mph) / 429 Nm*

*Hull Speed/Range – 8kts (9.2mph) / 1100 Nm*

**Propulsion option 2 – 2 x Cummins 550hp**

*Max Speed/Range – 25kts (28.7mph) / 314 Nm*

*Cruising Speed/Range – 20kts (23mph) / 407 Nm*

*Hull Speed/Range – 8kts (9.2mph) / 1100 Nm*

**All speeds are PRELIMINARY**

## Technical specification

**Length overall – 16.5 m / 54' 1"**

**Beam overall – 7.6 m / 24' 11"**

**Hull Draft – 0.74 m / 2' 5"**

**Max Draft – 1.2 m / 3' 11"**

**Air Draft – 5.95 m / 19' 6"**

**Light Ship Displacement – 27 t / 59 500 lbs**

**Design Category – A**

**Fuel Capacity – 2200L (720L range extenders) / 581 GAL (190 GAL range extenders)**

**Fresh water – 900L (230 GAL)**

**Generator - 1 x Kohler 16kW**

**Propulsion Standard – 2 x Volvo Penta D6-380 hp**

*Max Speed/Range – 19kts (22mph) / 415 Nm*

*Cruising Speed/Range – 16.5kts (19mph) / 480 Nm*

*Hull Speed/Range – 8kts (9.2mph) / 1160 Nm*

**Propulsion option 1 – 2 x Volvo Penta D6-480 hp**

*Max Speed/Range – 22.5kts (26mph) / 355 Nm*

*Cruising Speed/Range – 18kts (21mph) / 429 Nm*

*Hull Speed/Range – 8kts (9.2mph) / 1100 Nm*

**Propulsion option 2 – 2 x Cummins 550hp**

*Max Speed/Range – 25kts (28.7mph) / 314 Nm*

*Cruising Speed/Range – 20kts (23mph) / 407 Nm*

*Hull Speed/Range – 8kts (9.2mph) / 1100 Nm*

**All speeds are PRELIMINARY**











# SALON

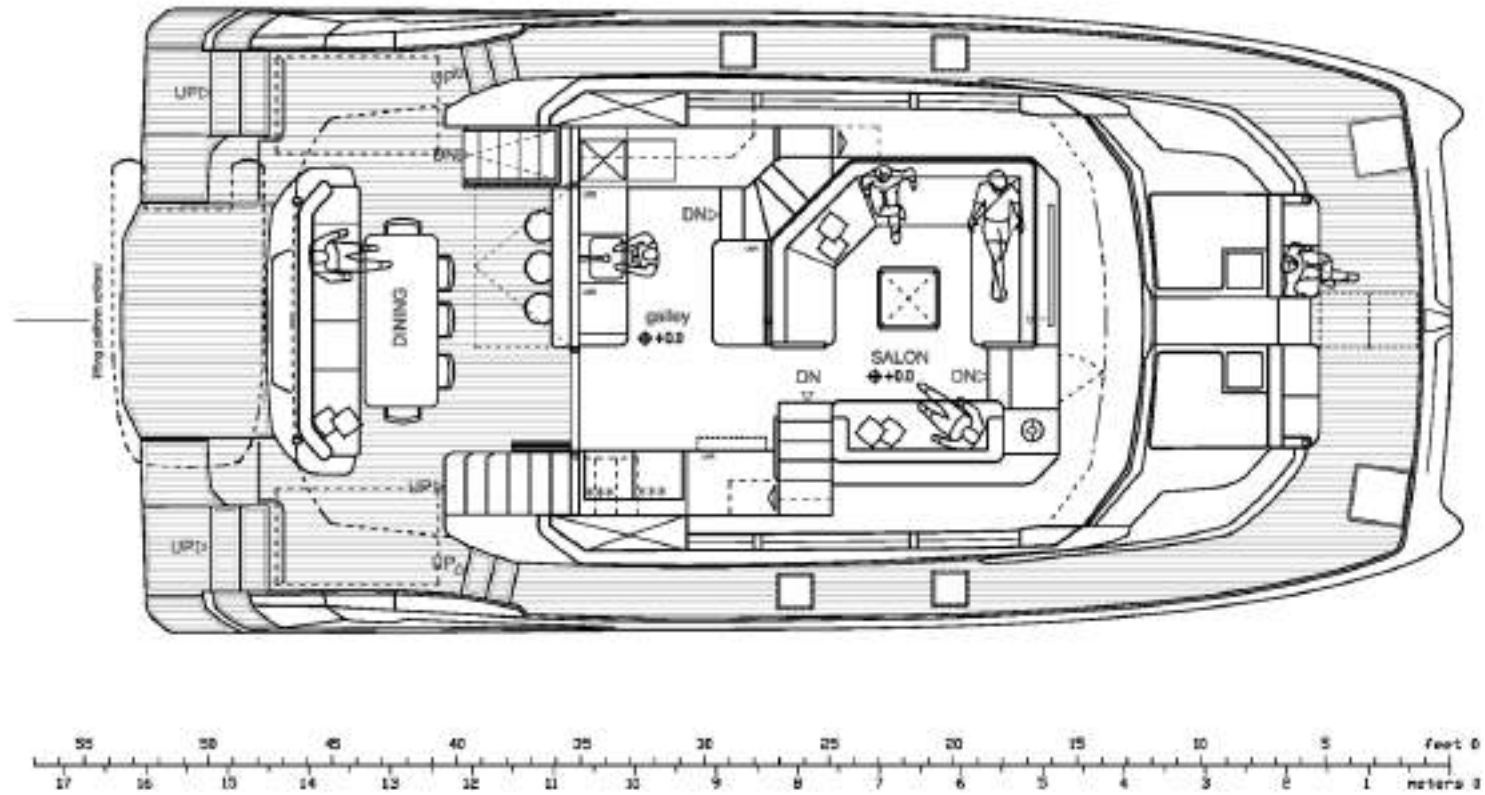

# SALON - inner steering

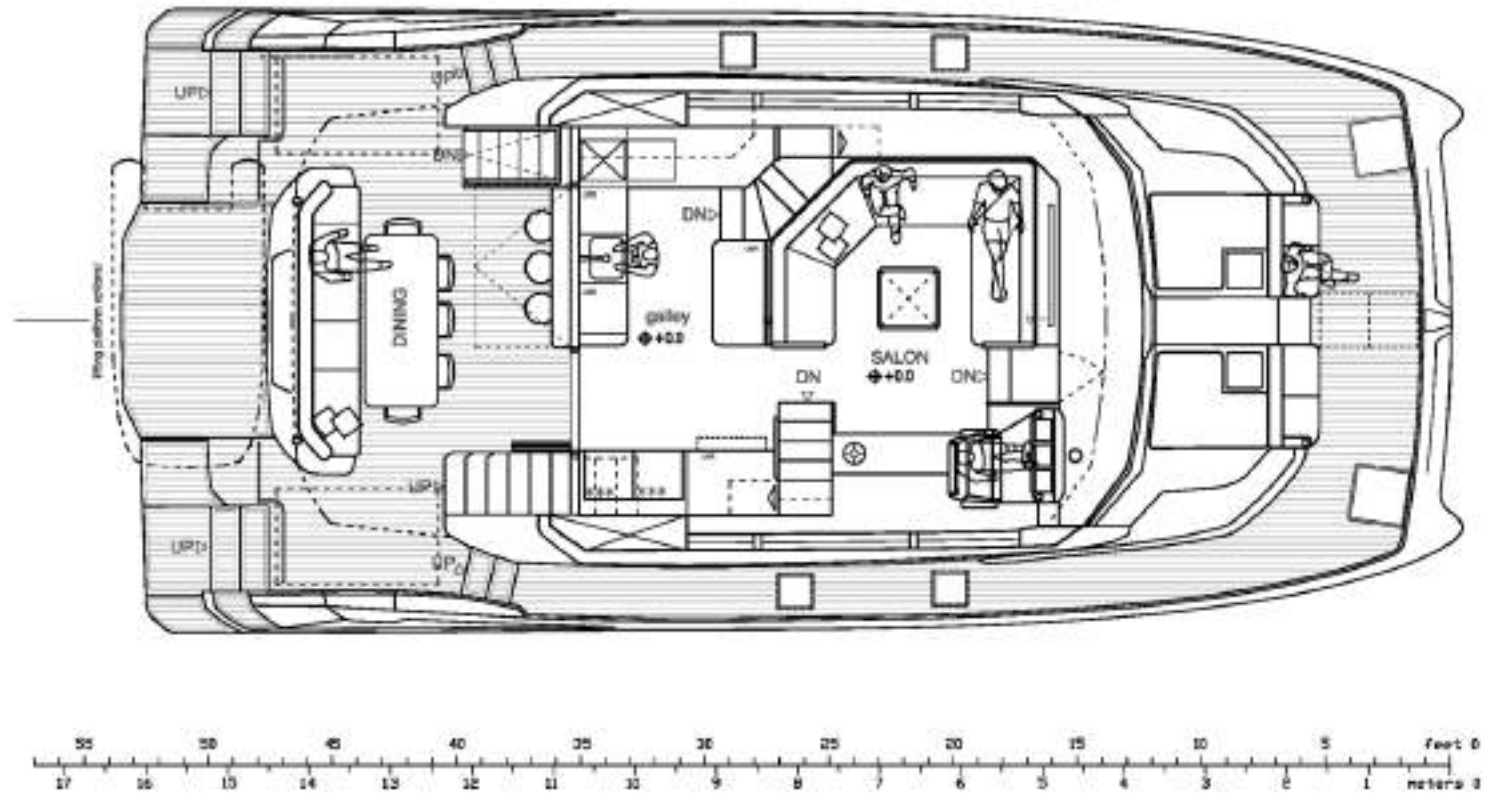

# SALON - galley down version

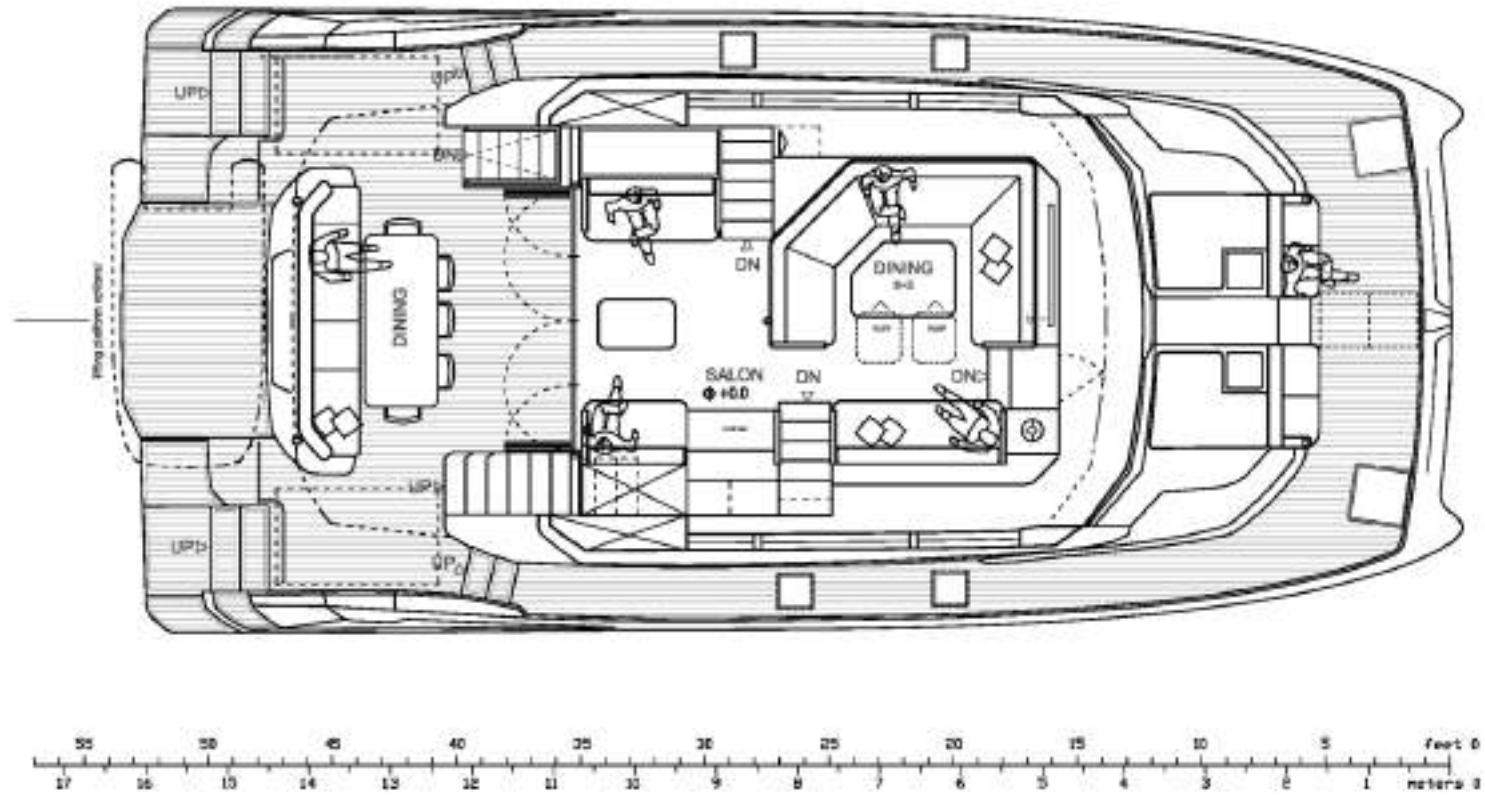

### 3 CABIN – lower deck layout

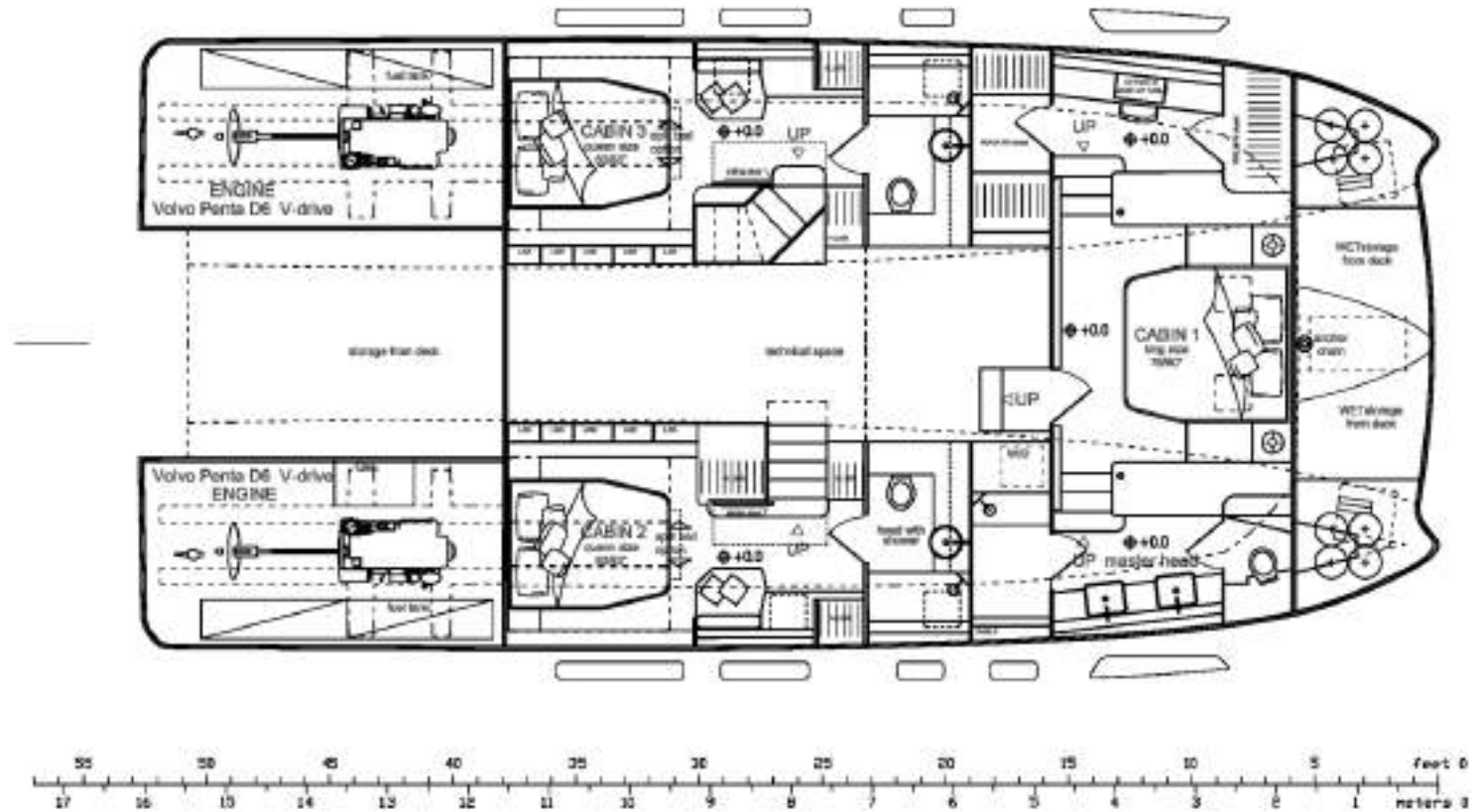

# 4 CABIN – lower deck layout

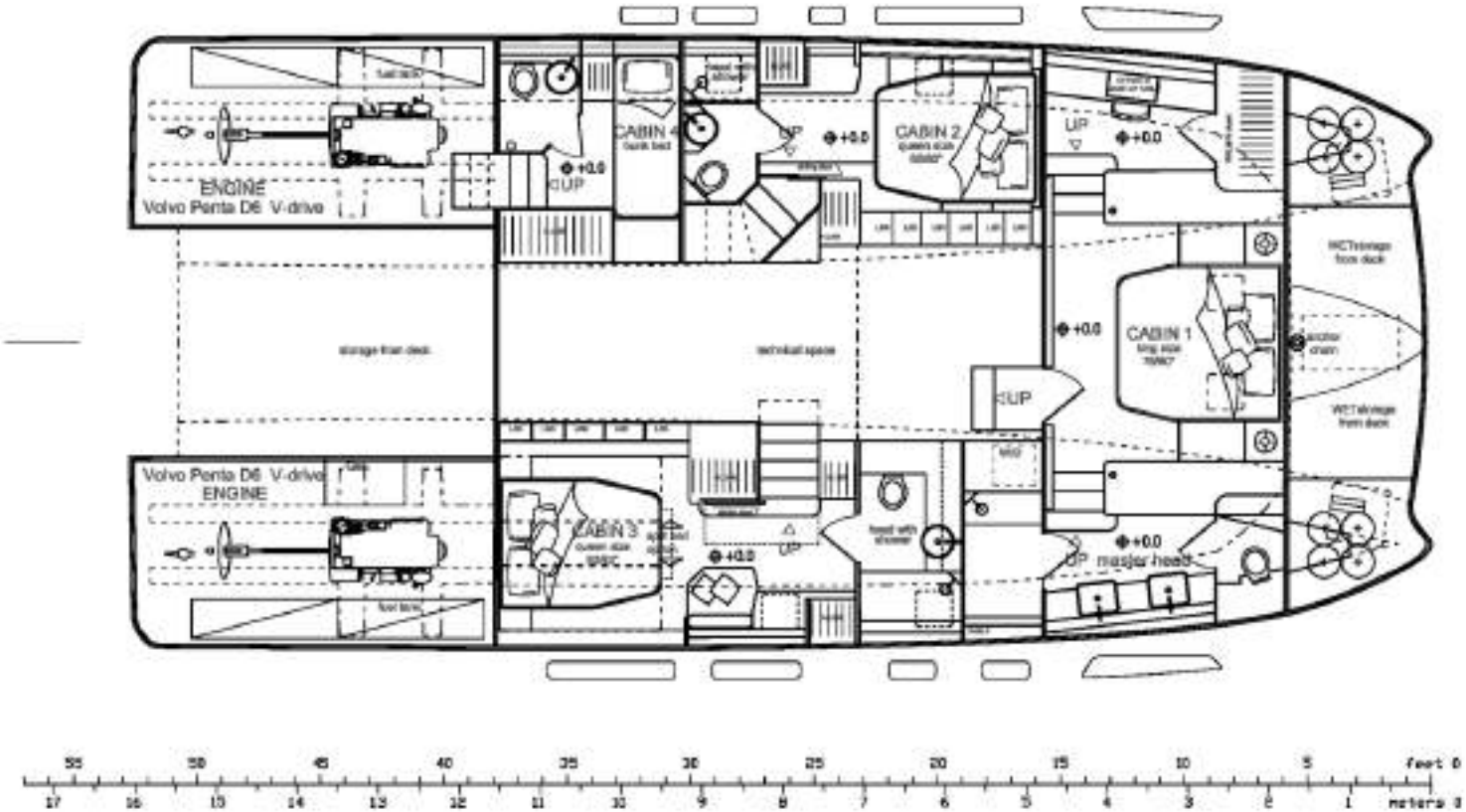

# 5 CABIN – lower deck layout

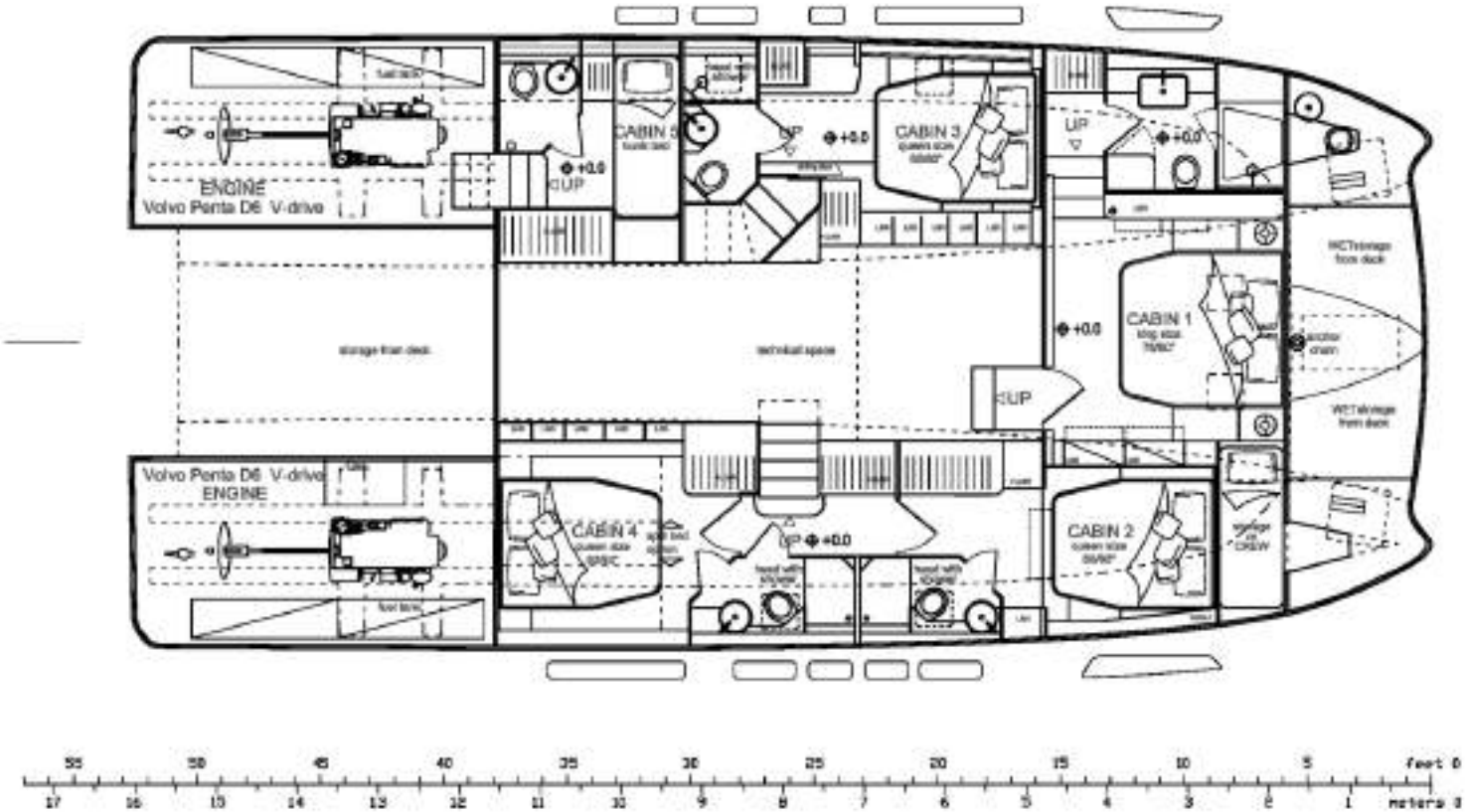

# 4 CABIN – galley down layout

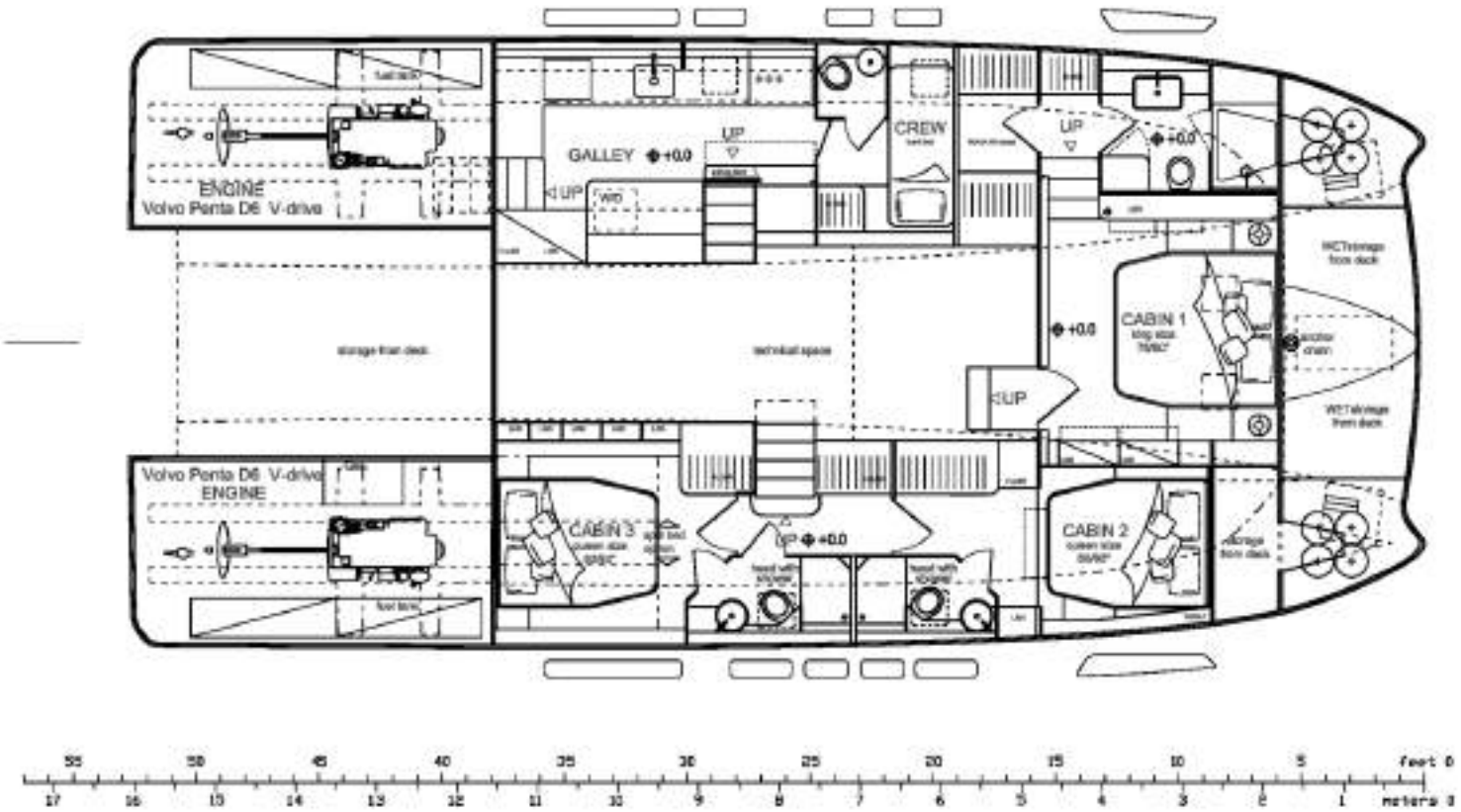

# FLYBRIDGE – open version

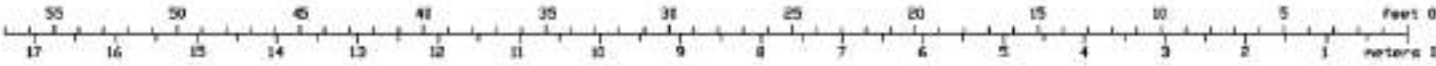
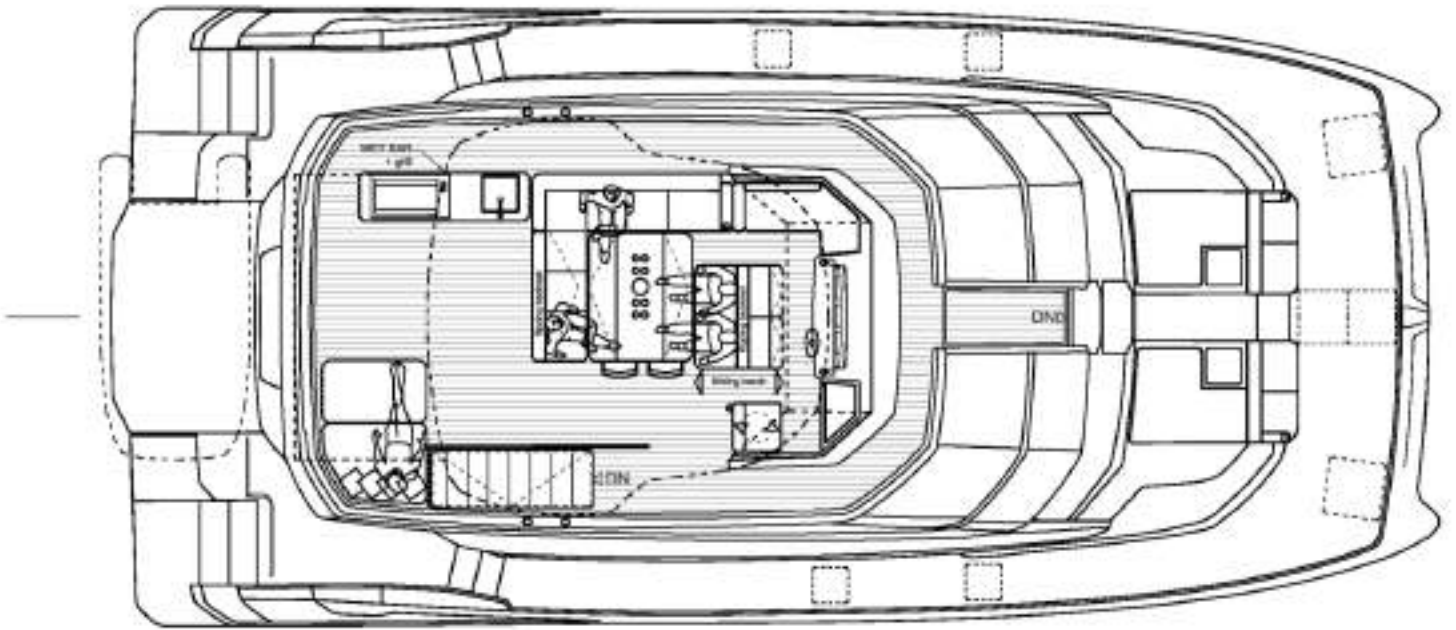
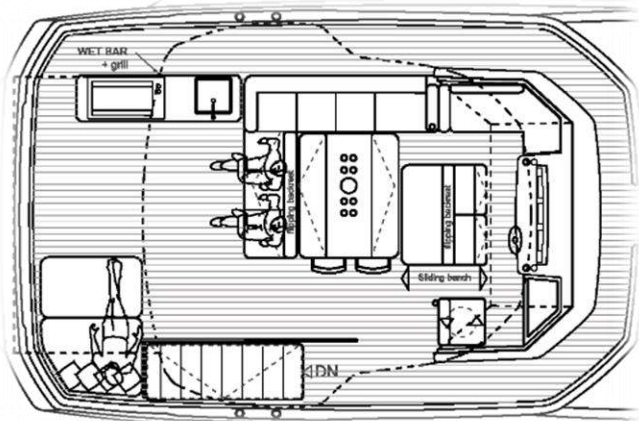

# FLYBRIDGE – Skylounge version

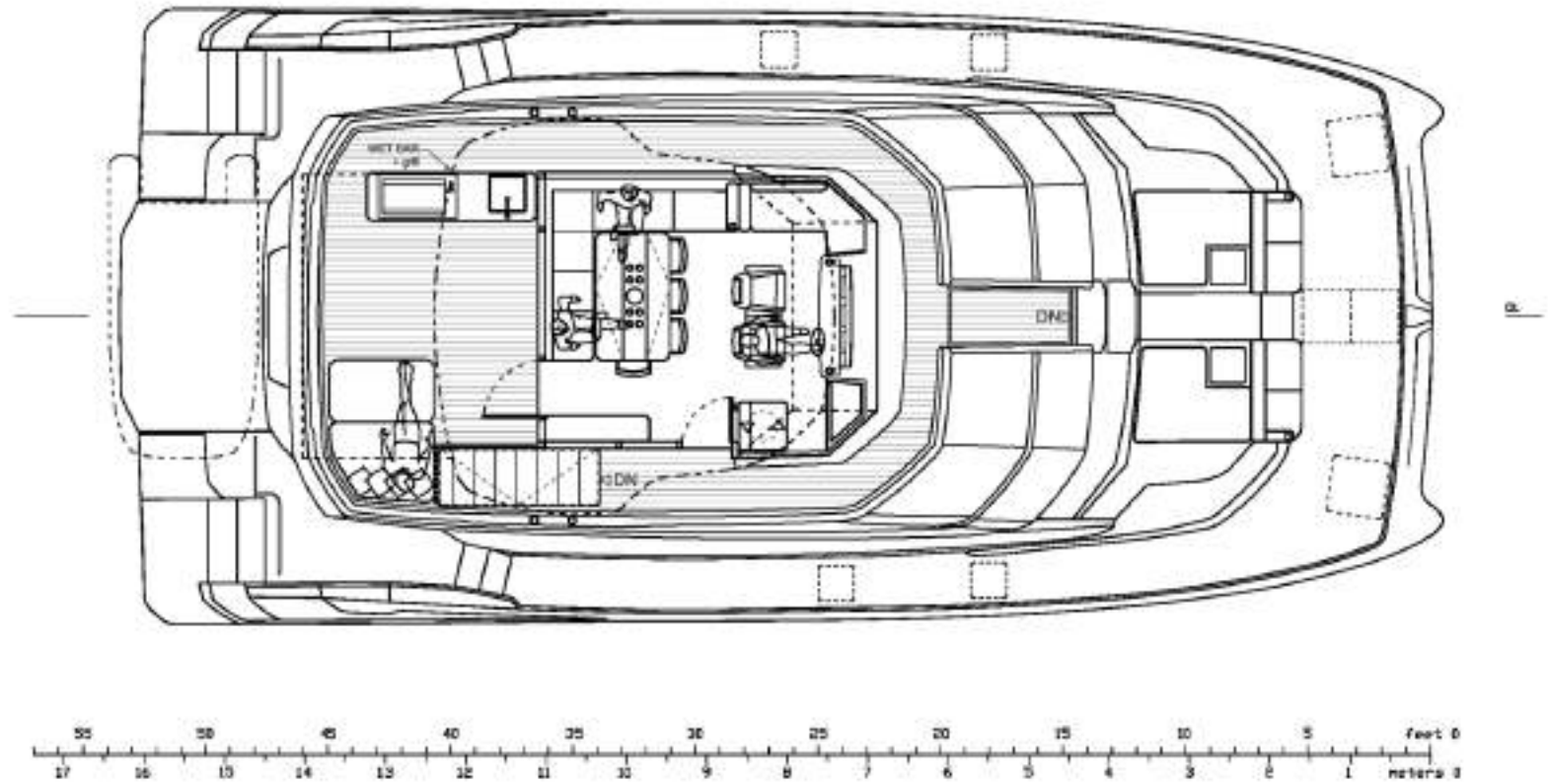

# SALON

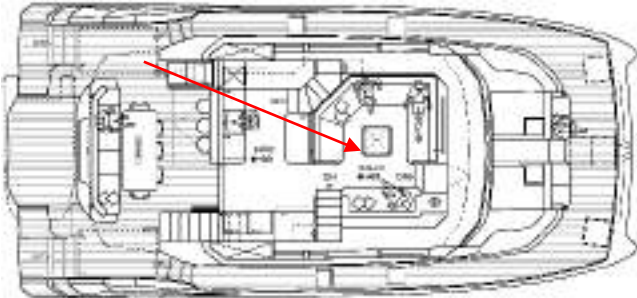

# SALON

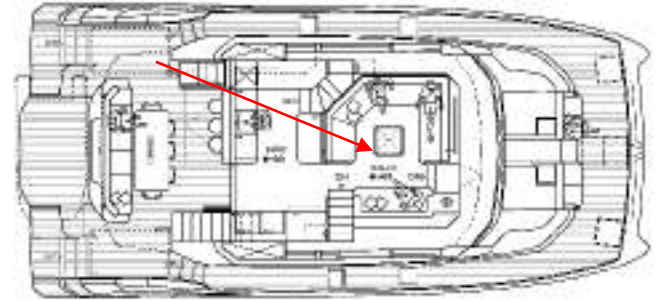

# SALON – inside steering

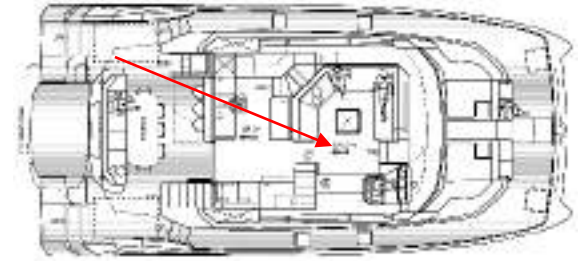

# MASTER CABIN



# STB GUEST CABIN

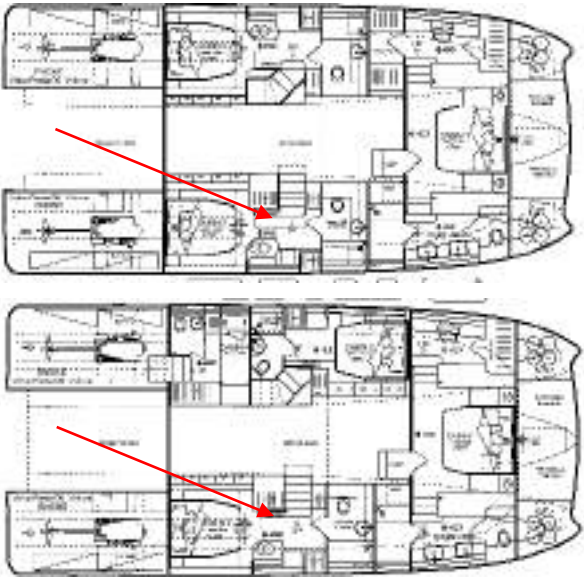

# PORT GUEST CABIN



# MASTER CABIN – 5 cabin version



# GUEST CABIN – 5 cabin version





<https://www.youtube.com/watch?v=XrLVc85WPe4>

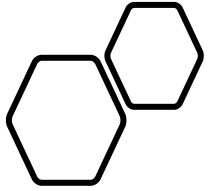

**Optional  
enclosed  
Flybridge  
external steps**



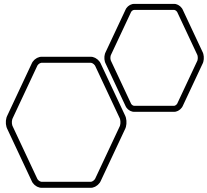

# Optional enclosed Flybridge external steps



# Optional enclosed Flybridge external steps



# Optional Internal steps and enclosed flybridge

## Finish on this option is upgraded



# Optional enclosed Flybridge external steps



# Optional Internal steps and enclosed flybridge



# Optional Internal steps and enclosed flybridge



# Asian Galley Down Version

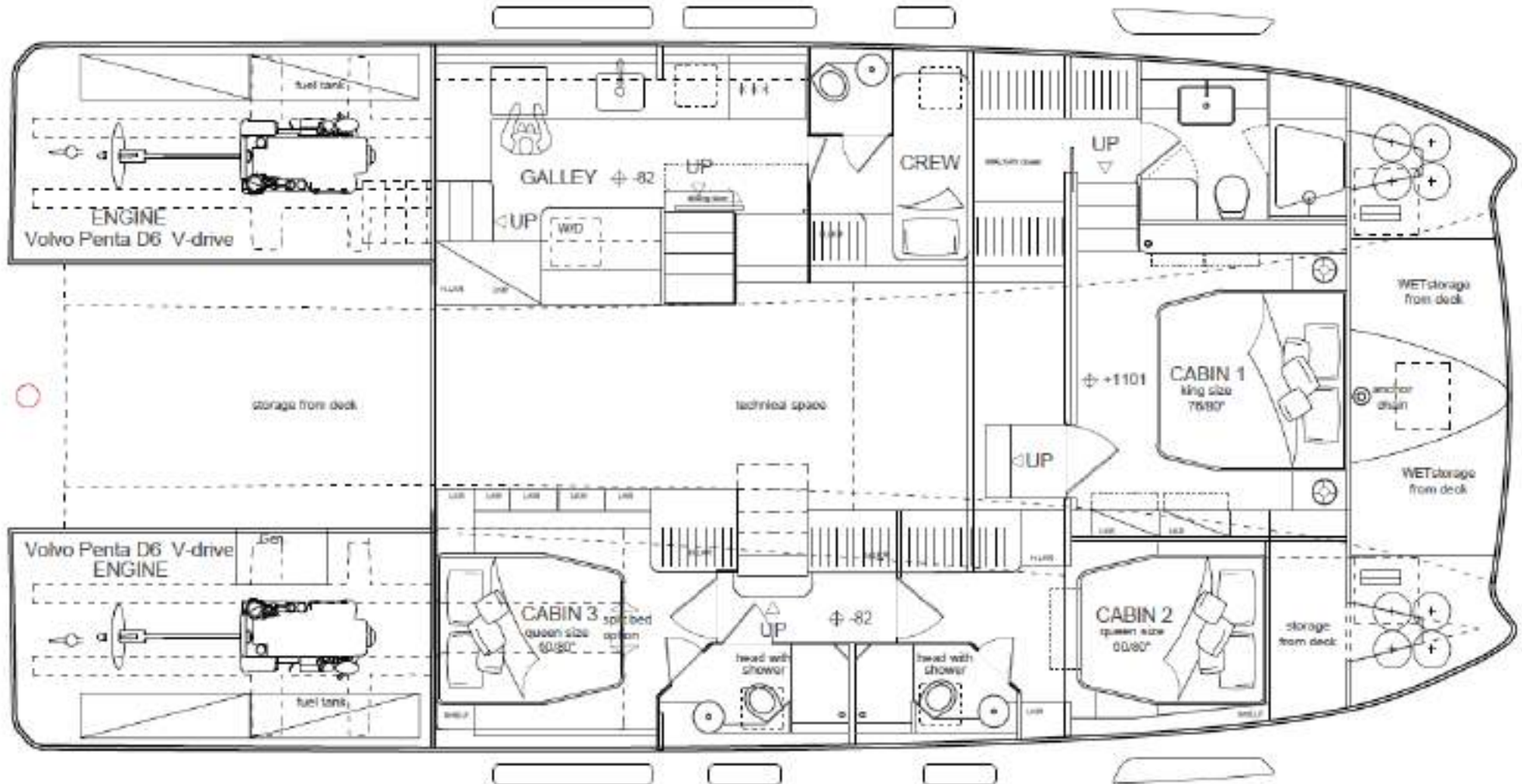

3 cabins version + galley down + crew

LA

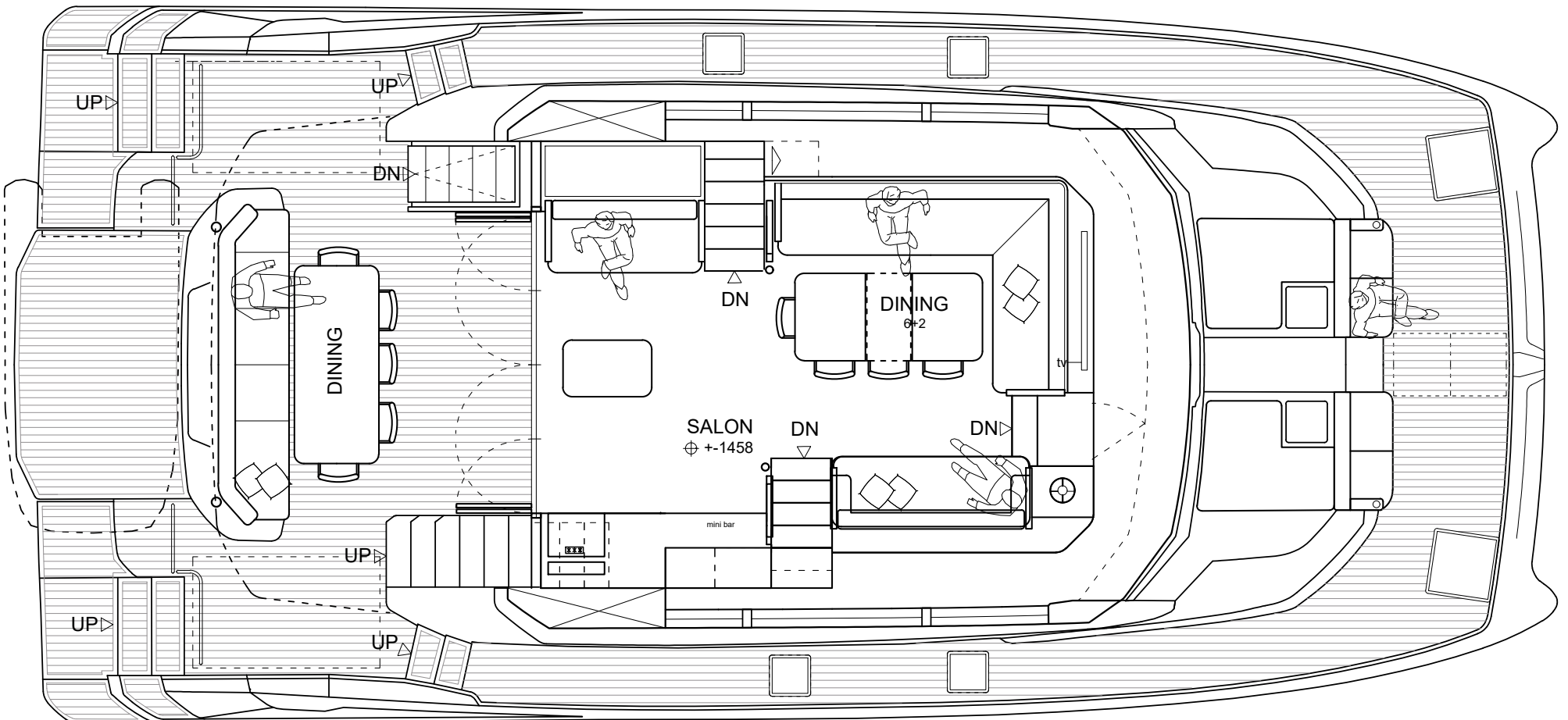

# Galley has access direct outside aft and into salon



# Crew cabin forward of galley directly connected



# Salon is expanded on galley down version



# Salon is expanded on galley down version



# Salon is expanded on galley down version



# Salon is expanded on galley down version



## Hull and 2 on line and hull 3 in mold



# Dinghy storage

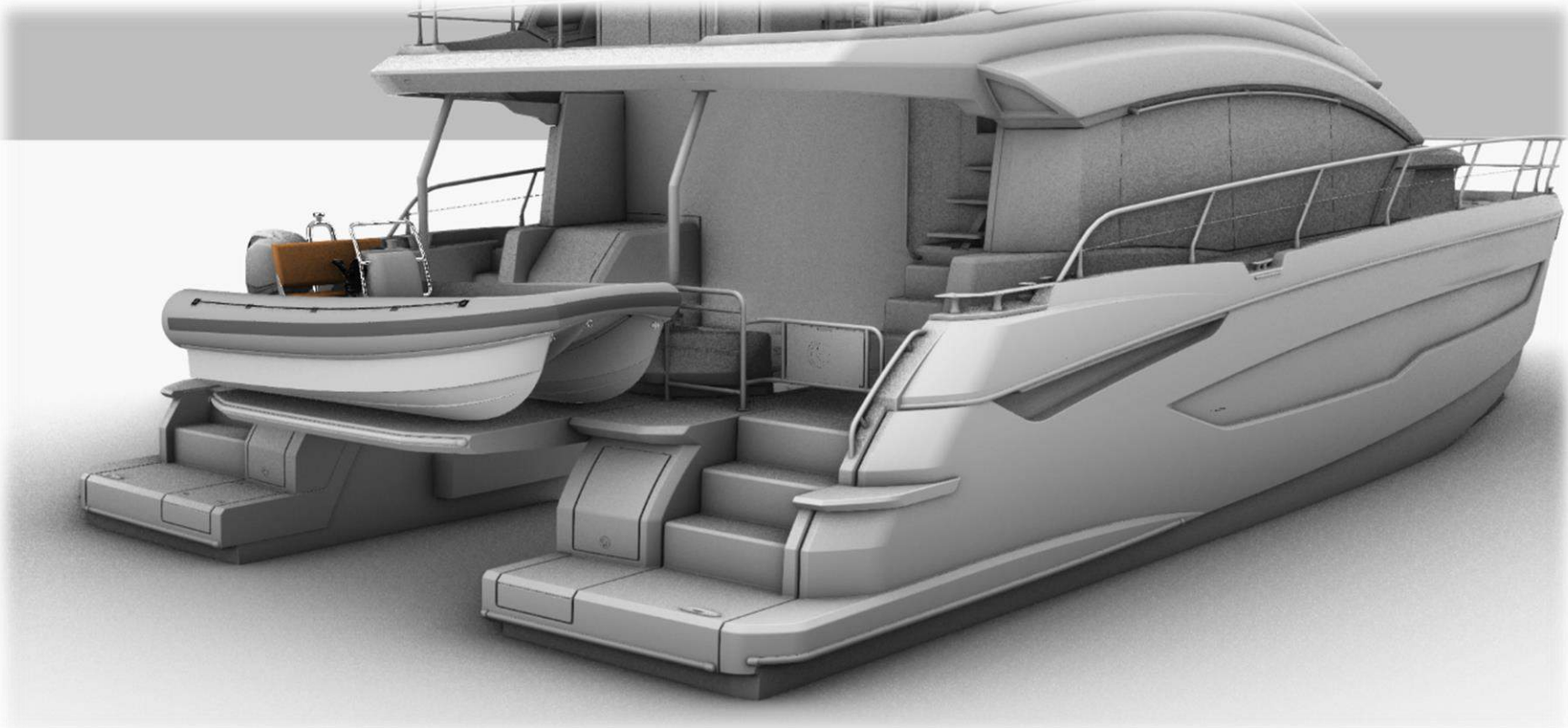

# Dinghy launching operation

